

# XS02 Load cells

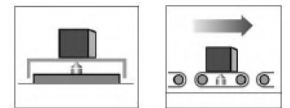
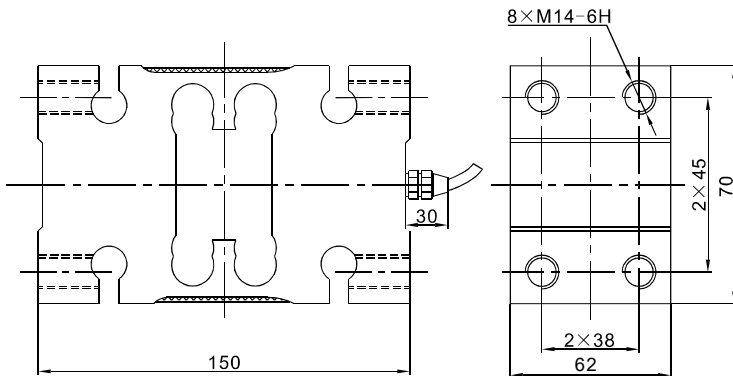

## Specifications 技术说明 Exc+激励正 (Red,红);Exc-激励负(Black,黑);Sig+信号正(Green,绿);Sig-信号负(White,白)

Item 项目	Unit 单位	Parameter 参数					
		C 2	C 3				
Accuracy class to OIML R60 精度等级		C 2	C 3				
<b>Maximum capacity (E<sub>max</sub>) 额定载荷</b>	<b>kg</b>	<b>50,100,200,300,500,750</b>					
<b>Sensitivity (C<sub>n</sub>) / Zero balance 灵敏度/零点平衡</b>	<b>mV/V</b>	<b>2.0 ± 0.2 / 0 ± 0.1</b>					
Temperature effect on zero balance (TK <sub>0</sub> ) 温度对零点影响	% of C <sub>n</sub> /10K	± 0.0175	± 0.0140				
Temperature effect on sensitivity (TK <sub>c</sub> ) 温度对灵敏度影响	% of C <sub>n</sub> /10K	± 0.0175	± 0.0140				
Hysteresis error (d <sub>hy</sub> ) 滞后误差	% of C <sub>n</sub>	± 0.02	± 0.0150				
Non-linearity(d <sub>lin</sub> ) 非线性误差	% of C <sub>n</sub>	± 0.0270	± 0.0167				
Creep(d <sub>cr</sub> ) over 30 min. 蠕变及蠕变恢复	% of C <sub>n</sub>	± 0.0250	± 0.0167				
Eccentric error 四角误差	%	± 0.0233					
<b>Input (R<sub>Lc</sub>) &amp; Output resistance (R<sub>o</sub>) 输入&amp;输出电阻</b>	<b>Ω</b>	<b>382 ± 15 &amp; 352 ± 3</b>					
<b>Nominal range of excitation voltage (B<sub>u</sub>) 额定电压</b>	<b>V</b>	<b>5~15</b>					
Insulation resistance (R <sub>is</sub> ) at 50Vdc 绝缘电阻	M Ω	≥ 5000					
Service temperature range (B <sub>tu</sub> ) 工作温度	°C	-20...+50					
Safe load limit (E <sub>L</sub> ) & Breaking load(E <sub>d</sub> ) 安全承载&破坏载荷	% of E <sub>max</sub>	120 & 200					
<b>Protection class according to EN 60 529 (IEC 529) 保护等级</b>		<b>IP65</b>					
Material :Measuring element 材料:测量元件		合金钢 Alloy Steel					
Maximum capacity (E <sub>max</sub> ) 额定载荷	kg	50	100	200	300	500	750
Min. load cell verification inter(v <sub>min</sub> ) 最小检定分度值	g	20	20	50	50	100	100
Maximum platform size 最大秤台尺寸	mm	800 × 800					
Deflection at E <sub>max</sub> (s <sub>nom</sub> ) ,approx最大载荷下的变形量	mm	< 0.6					
Weight(G),approx 重量	kg	4.3			4.5		
Cable 电缆: Diameter 直径: ∅5mm Length 长度	m	3m					
Mounting:Cylindrical head screw 装配:内六角圆柱头螺钉		M14-10.9					
Tightening torque 螺丝紧固力矩	N. m	35N.m					