

LFS02

Load cells

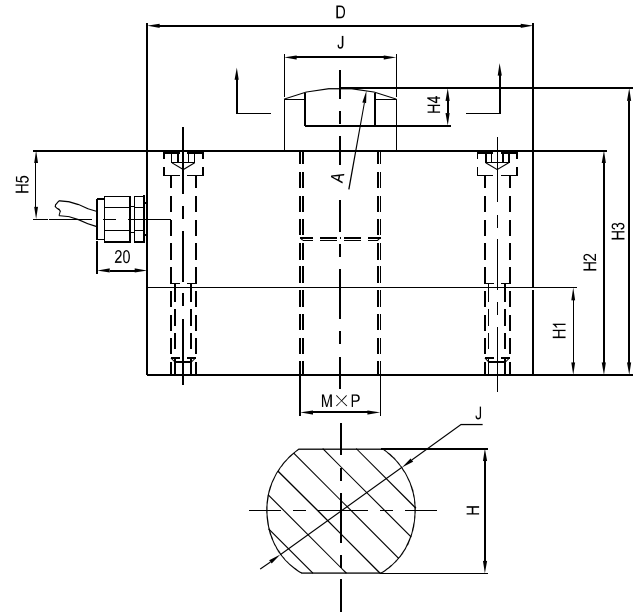

Emax[t]	D	M×P	H1	H2	H3	H4	H5	H	J	A
2,3	∅105	M14×2	25	70	85	10	22.5	20	∅25	SR40
5	∅120	M20×1.5	30	80	95	10	25	25	∅30	SR45
10,20	∅155	M32×2	35	90	115	15	27.5	35	∅45	SR60

Specifications 技术说明 Exc+激励正 (Red,红);Exc-激励负(Black,黑);Sig+信号正(Green,绿);Sig-信号负(White,白)

Item 项目	Unit 单位	Parameter 参数				
Accuracy class to OIML R60 精度等级		D1			0.1	
Maximum capacity (Emax) 额定载荷	t	2,3,5			10,20	
Minimum LC verification interval (Vmin) 最小检定分度值	% of Emax	0.0200			0.0350	
Sensitivity (Cn) / Zero balance 灵敏度/零点平衡	mV/V	2.0 ± 0.005 / 0 ± 0.02				
Temperature effect on zero balance (TK0) 温度对零点影响	% of Cn/10K	±0.02			±0.0252	
Temperature effect on sensitivity (TKc) 温度对灵敏度影响	% of Cn/10K	±0.02			±0.0252	
Hysteresis error (dhy) 滞后误差	% of Cn	±0.0500			±0.1000	
Non-linearity(dlin) 非线性误差	% of Cn	±0.0500			±0.1000	
Creep(dcr) over 30 min. 蠕变及蠕变恢复	% of Cn	±0.0300			±0.0490	
Input (RLc) & Output resistance (R0) 输入&输出电阻	Ω	750 ± 10 & 703 ± 2				
Nominal range of excitation voltage (Bu) 额定电压	V	5~12				
Insulation resistance (Ris) at 50Vdc 绝缘电阻	M Ω	>5000				
Service temperature range (Btu) 工作温度	°C	-30...+70				
Safe load limit (EL) & Breaking load(Ed) 安全承载&破坏载荷	% of Emax	150 & 200				
Protection class according to En 60 529 (IEC 529) 保护等级		IP67				
Material : Measuring element 材料:测量元件 Cable fitting 电缆配件/Cable sheath 电缆护套		Alloy steel Stainless steel /PVC				
Maximum capacity (Emax) 额定载荷	t	2	3	5	10	20
Deflection at Emax (snom) ,approx 最大载荷下的变形量	mm	<0.3		<0.4	<0.5	
Weight(G),approx 重量	kg	3.8		5.3	9.3	
Cable 电缆: Diameter 直径: ∅6mm Length 长度	m	5		5	12	